

# Type **TW05**

**WEH<sup>®</sup> Connector for pneumatic pressure and function testing**  
of components with internal thread



General

**DESCRIPTION**



**Features**

- Connection in seconds
- No hand tightening required
- WEH® Jaw locking mechanism
- Simple seal replacement
- Ergonomic design
- Compact design
- High-grade materials
- Automation possible

With the WEH® TW05 Quick connector pneumatic components are tested faster than ever before. Connecting and pressure impacting of the test piece is accomplished in one operation by simple actuation of the sliding sleeve. In this way, costly testing times are shortened and the quick connector pays for itself in a very short time.

**Application**

Quick connector for pneumatic pressure and function testing of components with internal thread, e.g. cylinders, valves, fixtures, pivot drives etc.

**Note:** For using the WEH® Connectors with pneumatic actuation and clamping jaws in an automated system please observe the technical note on page 69 in catalogue no. 35.

**TECHNICAL DATA**

Characteristics	Basic version
Max. allowable operating pressure PS	5 - 12 bar compressed air
Temperature range	+5 °C up to +80 °C
Leak rate	1 x 10 <sup>-3</sup> mbar x l/s
Material	Clamping jaws: Corrosion-resistant stainless steel Outer parts: Anodized aluminium
Sealing material	Front seal of NBR
Conformity / Tests / Approvals	Pressure Equipment Directive 2014/68/EC

Other designs on request

**Example of use:**



Ordering

**ORDERING** | WEH® TW05 Quick connector

approx. dimensions (mm)

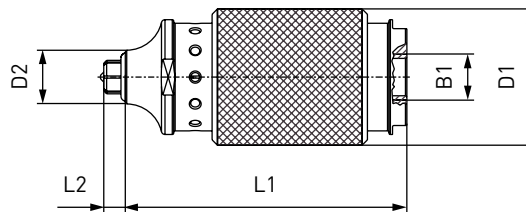

Body size	B1 (internal thread)	D1	D2	D3	L1	L2
1	G1/4"	38.0	15.0	-	78.5	6.0
2	G1/4"	38.0	19.0	-	78.5	6.0
3	G1/2"	48.0	23.5	-	82.5	6.5
4	G1/2"	48.0	27.0	-	83.0	6.0

Whitworth tube thread to DIN EN ISO 228-1 - acc. to DIN 3852 part 2, form X and Y

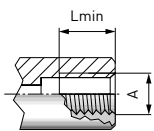

Part no.	Body size	Thread A (internal thread)	Lmin*
<b>TW05-W8000-045</b>	1	G1/8"	7.0
<b>TW05-W8001-045</b>	2	G1/4"	9.5
<b>TW05-W8002-085</b>	3	G3/8"	10.5
<b>TW05-W8003-085</b>	4	G1/2"	10.5

\* Lmin: minimum thread length  
Other connector sizes on request

NPT thread (ANSI/ASME B1.20.1-1983) - acc. to SAE J476a

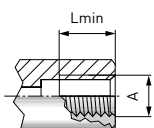

Part no.	Body size	Thread A (internal thread)	Lmin*
<b>TW05-W8006-045</b>	1	NPT 1/8"	7.0
<b>TW05-W8007-045</b>	2	NPT 1/4"	9.5
<b>TW05-W8008-085</b>	3	NPT 3/8"	10.5
<b>TW05-W8009-085</b>	4	NPT 1/2"	10.5

\* Lmin: minimum thread length  
Other connector sizes on request

Other connector versions on request.

Required information for ordering see page 7, catalogue no. 35.

Other products

**OTHER PRODUCTS**

You will find more products in our current catalogue no. 35



Further information on our homepage  
[www.weh.com](http://www.weh.com)

» **Contact**

For queries and further information, please do not hesitate to contact us.

*Manufacturer:*

**WEH GmbH Precision Connectors**

Josef-Henle-Str. 1  
89257 Illertissen / Germany

Phone: +49 7303 9609-0  
Fax: +49 7303 9609-9999

Email: [sales@weh.com](mailto:sales@weh.com)  
[www.weh.com](http://www.weh.com)